

Top view
Scale: 1:25

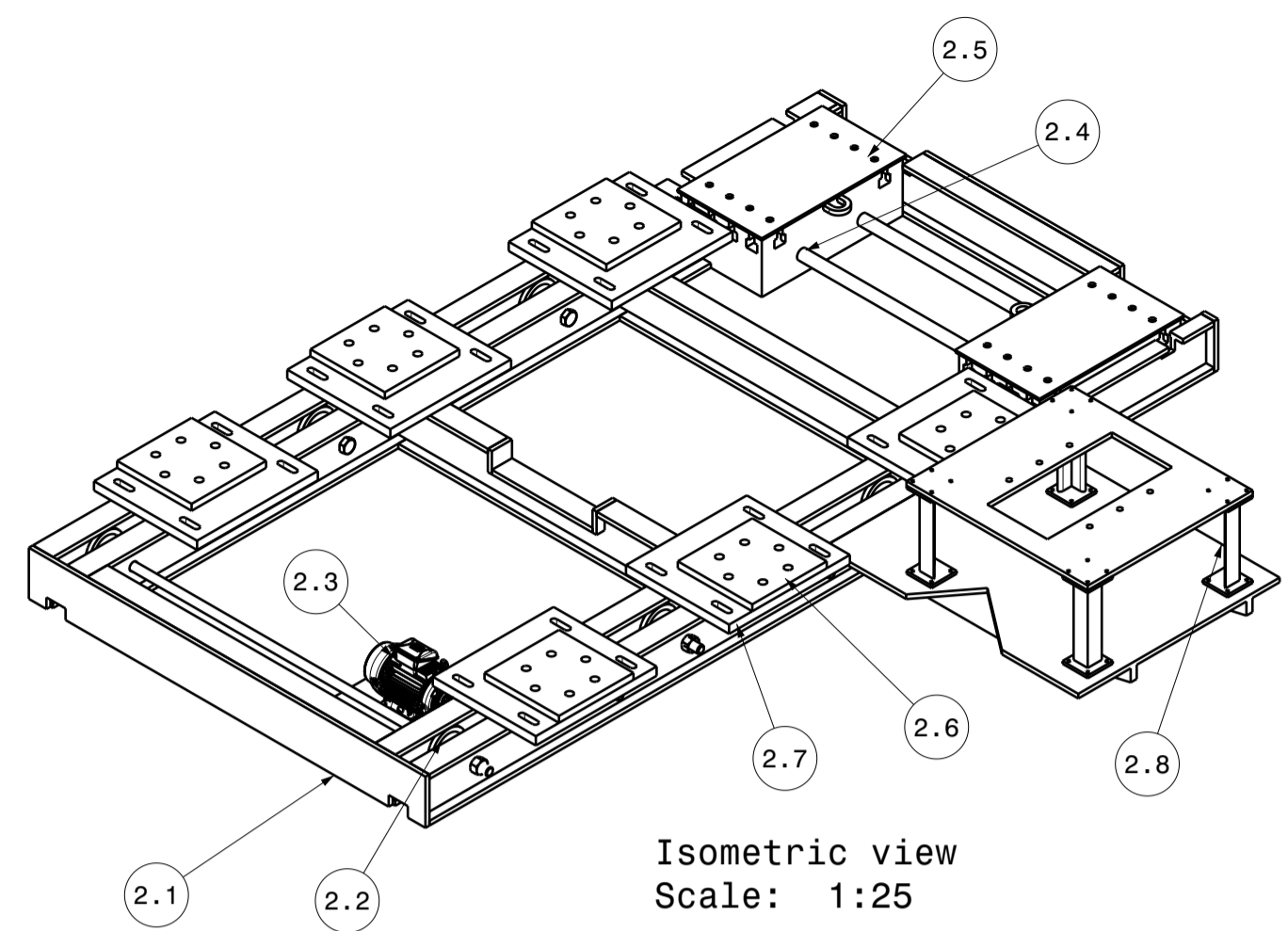

Isometric view
Scale: 1:25

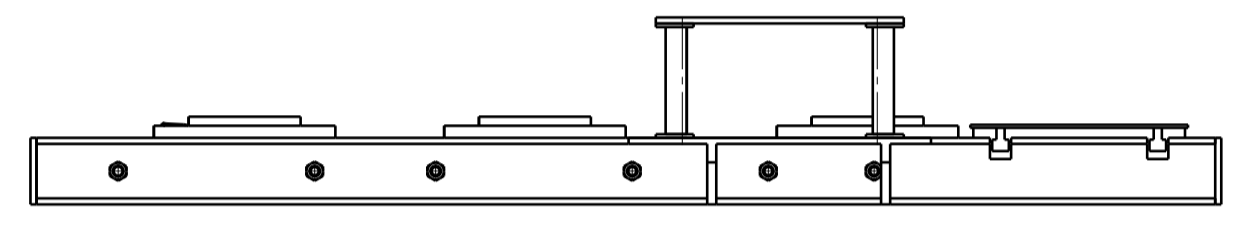

Front view
Scale: 1:25

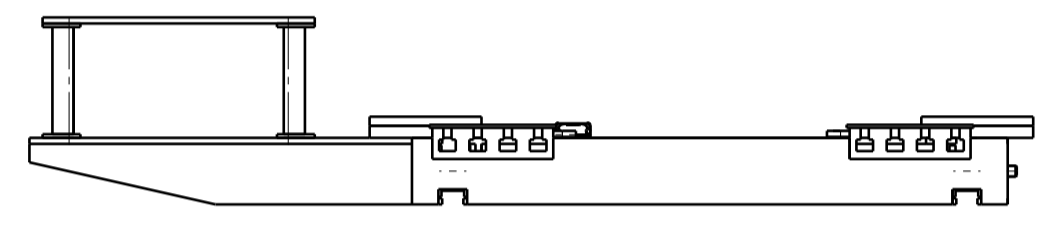

Right view
Scale: 1:25

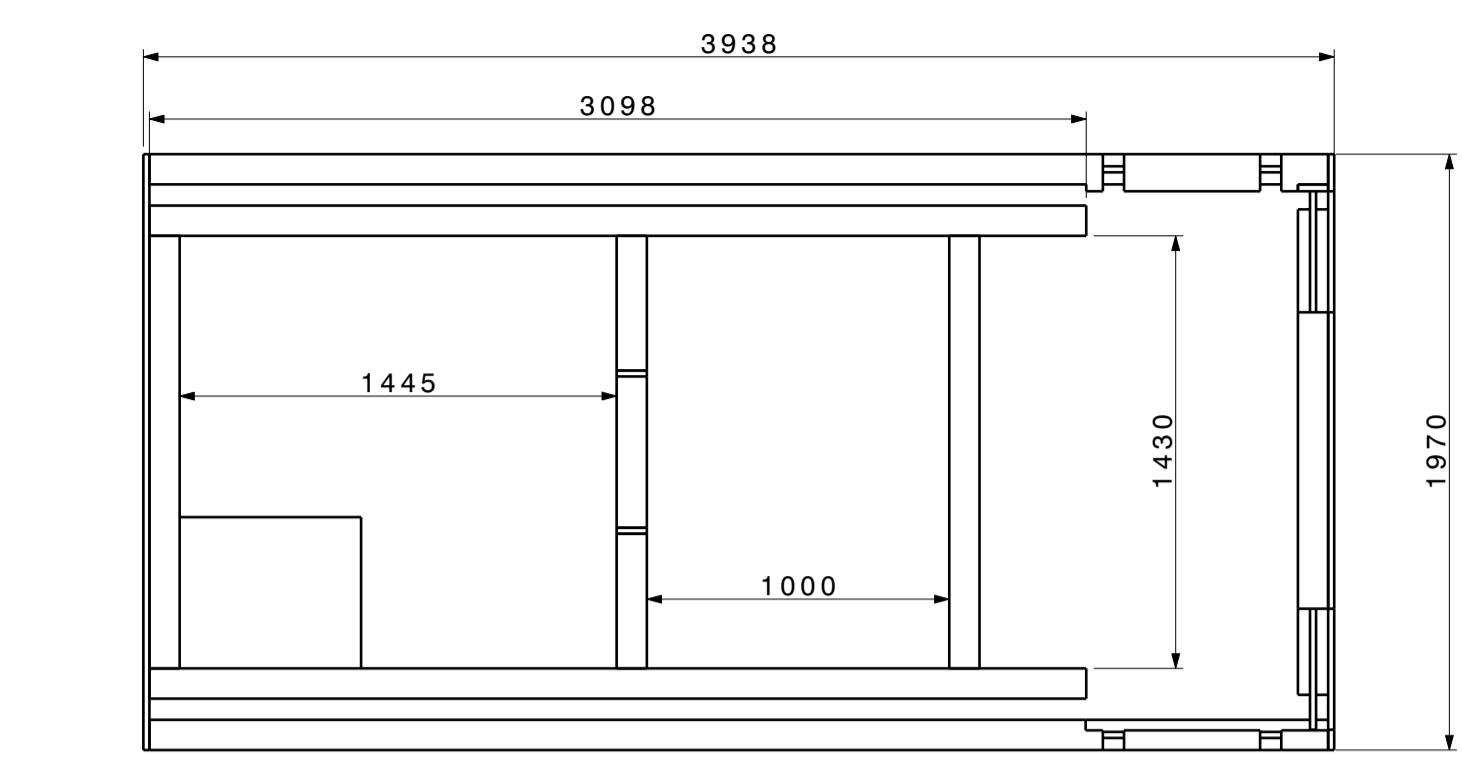

Top view
Scale: 1:25

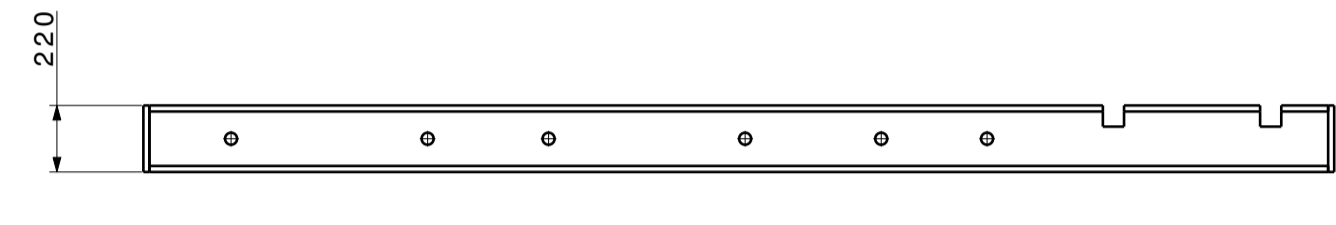

Front view
Scale: 1:25

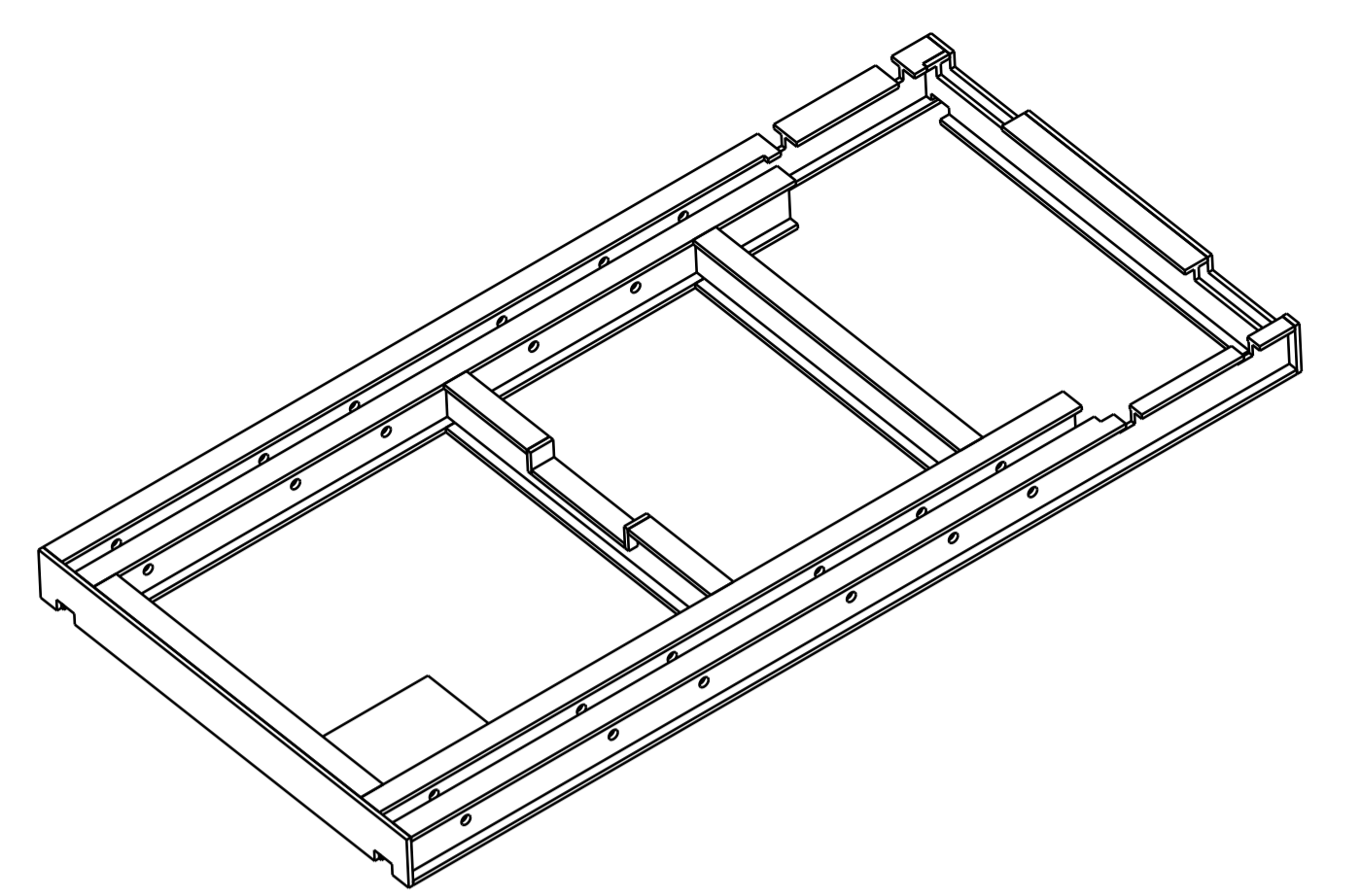

Isometric view
Scale: 1:25

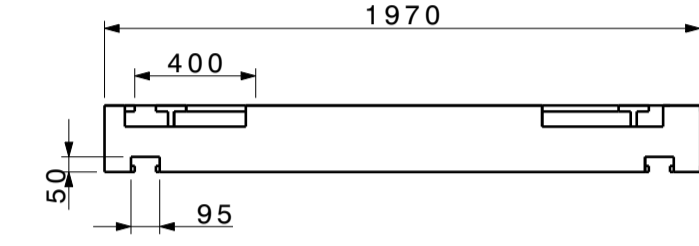

Right view
Scale: 1:25

2.1

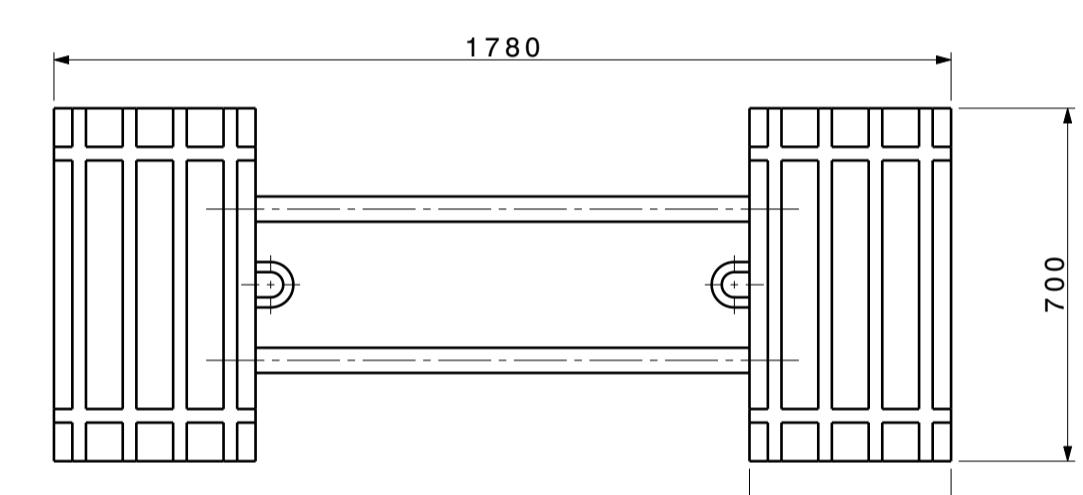

Top view
Scale: 1:15

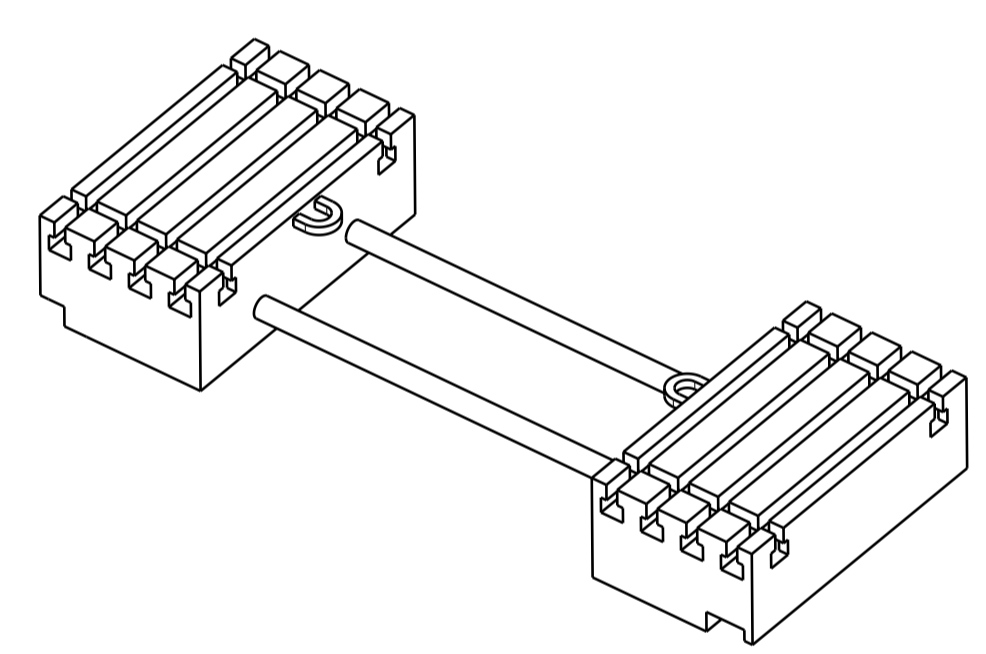

Isometric view
Scale: 1:15

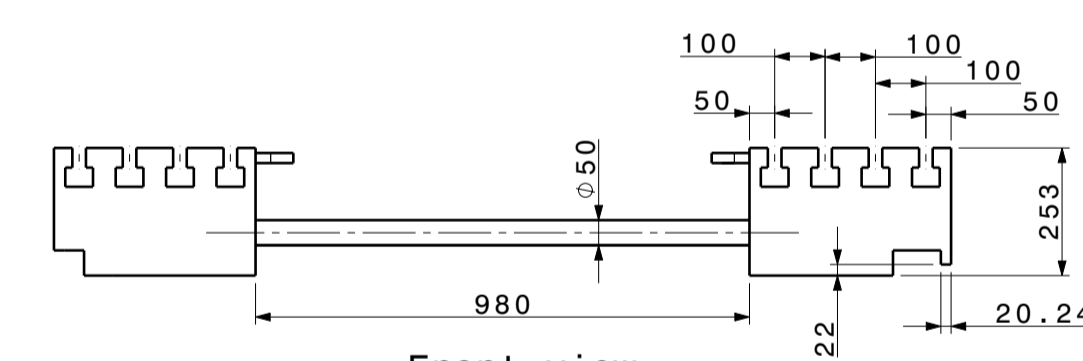

Front view
Scale: 1:15

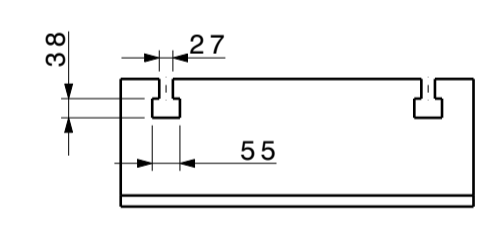

Right view
Scale: 1:15

2.4

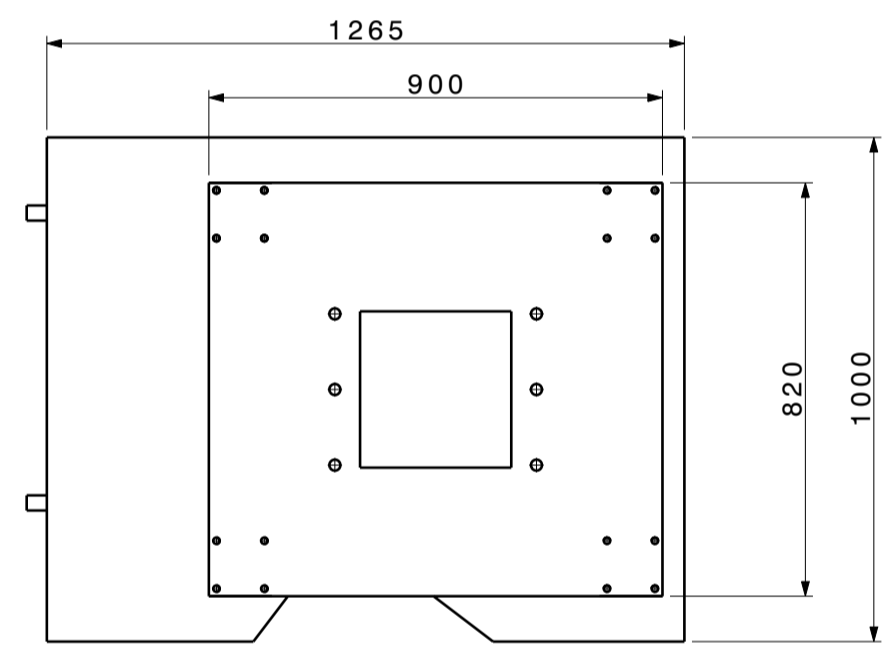

Top view
Scale: 1:15

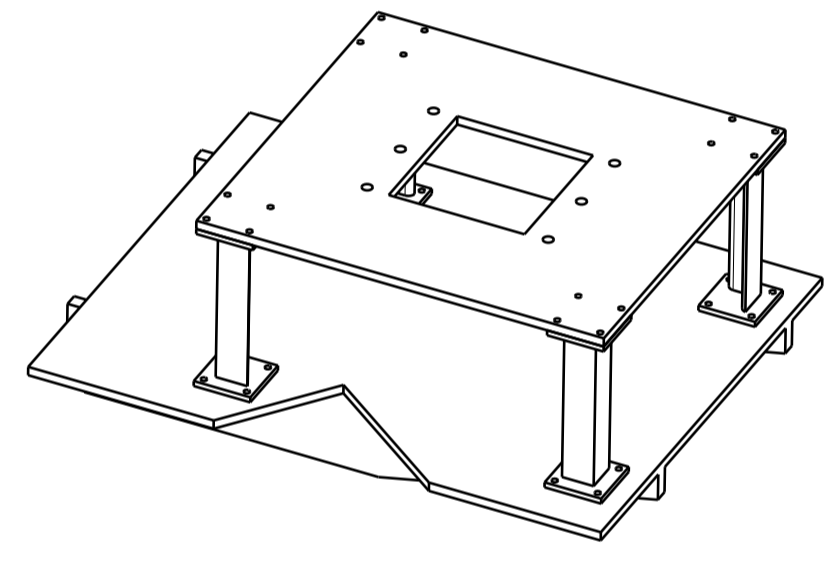

Isometric view
Scale: 1:15

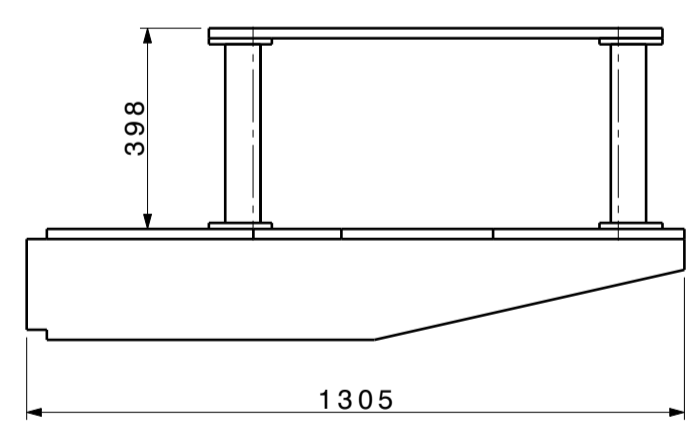

Front view
Scale: 1:15

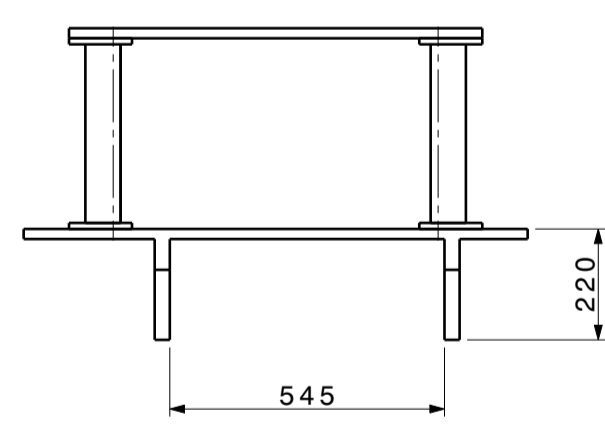

Right view
Scale: 1:15

2.8

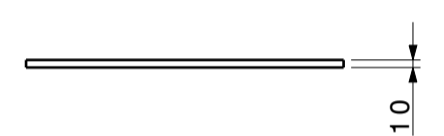

Top view
Scale: 1:10

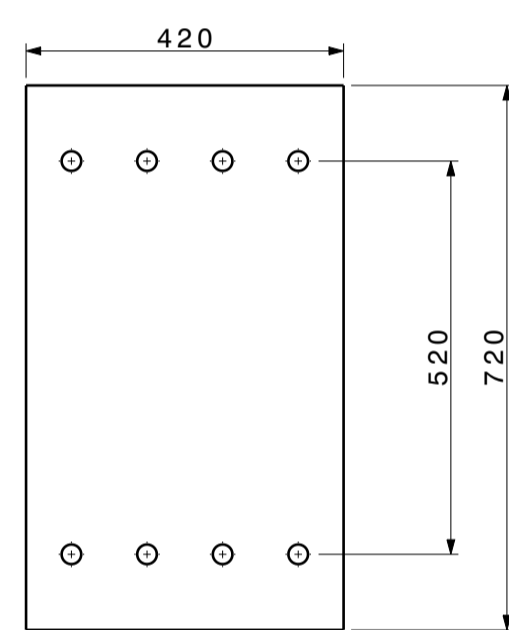

Front view
Scale: 1:10

2.5

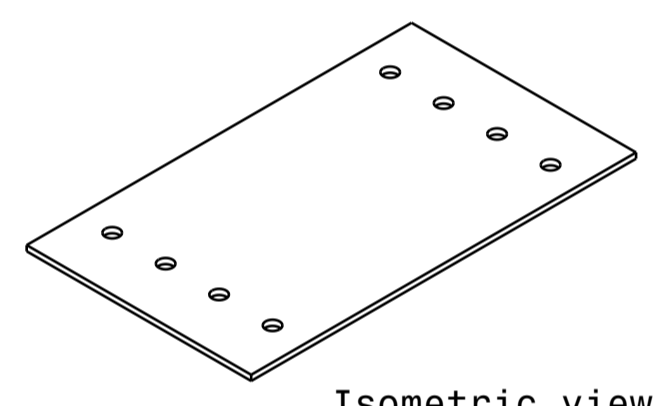

Isometric view
Scale: 1:10

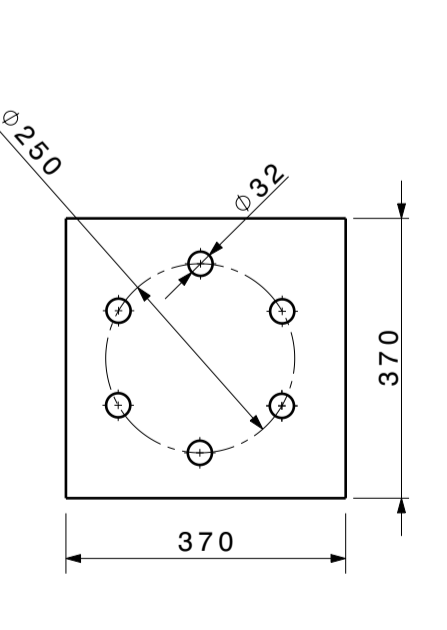

Top view
Scale: 1:10

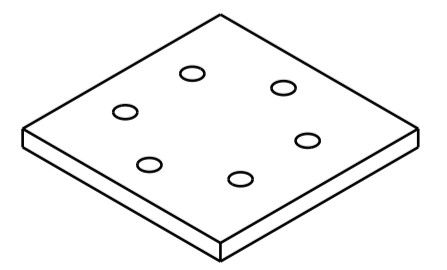

Isometric view
Scale: 1:10

2.6

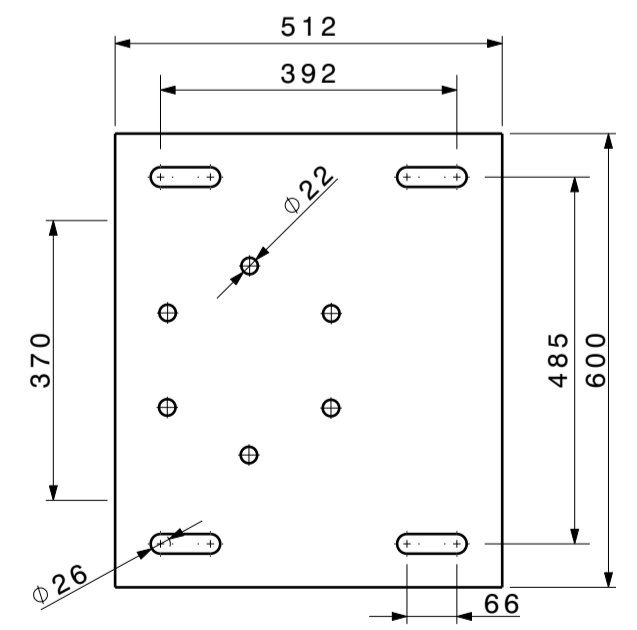

Top view
Scale: 1:10

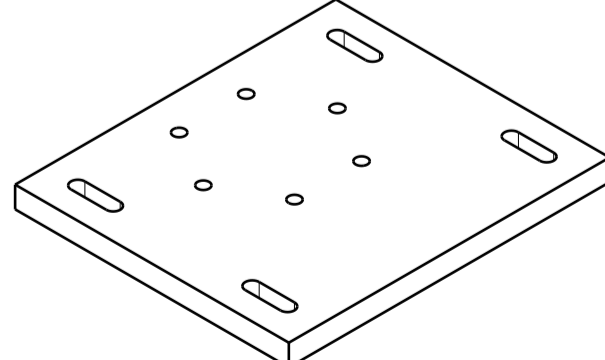

Isometric view[2]
Scale: 1:10

2.7

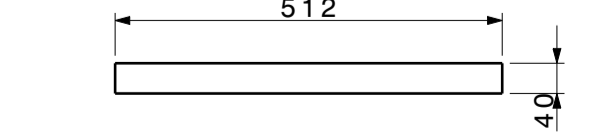

Front view
Scale: 1:10

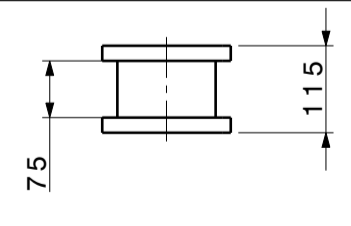

Top view
Scale: 1:10

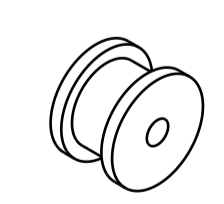

Isometric view
Scale: 1:10

2.2

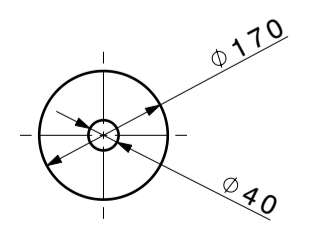

Front view
Scale: 1:10

| PART NO. | DESCRIPTION (CARRIAGE) | MATERIAL | QTY. | REMARKS |
|----------|-----------------------------------|----------|------|---------|
| 2.1 | FRAME | SS 304 | 1 | |
| 2.2 | WHEELS ASSEMBLY | SS 304 | 12 | |
| 2.3 | MOTOR ASSEMBLY | SS 304 | 1 | |
| 2.4 | GATE VALVE SUPPORT | SS 304 | 1 | |
| 2.5 | ISOLATION PADS FOR GATE VALVE | G10 | 2 | |
| 2.6 | ISOLATION PADS FOR VESSEL SUPPORT | G10 | 6 | |
| 2.7 | VESSEL SUPPORT | SS 304 | 6 | |
| 2.8 | PUMPING STATION SUPPORT | SS 304 | 1 | |

| DRG. NO | 8-25 | 1.6-8 | 0.025-1.6 | < 0.025 | REVISION COLUMN | | | | NBI GROUP: | SIZE | INSTITUTE FOR PLASMA RESEARCH | | |
|--|---------|---------|--------------|---------------|-----------------|------|-------------|---------|------------|-------------|-------------------------------|------|-------|
| CO-ORDINATED BY | 1 | 1 | 1 | 1 | REV | ZONE | DESCRIPTION | DATE | REMARKS | APPROVED BY | SCALE | DATE | TITLE |
| MACHINING DEVIATIONS FOR NON-TOLERANCED DIMENSIONS | | | | | | | | | | | | | |
| LENGTH IN mm OF SHORTER SIDE OF ANGLES | | | | LENGTH OR DIA | UPTO 6 | 6-30 | 30-120 | 120-315 | | | | | |
| UPTO 10 | 10-50 | 50-120 | OVER 120-400 | | ±0.1 | ±0.2 | ±0.3 | ±0.5 | | | | | |
| ±1 | +0'-30' | +0'-20' | +0'-10' | | | | | | | | | | |
| DRAWN ARK | | | | | | | | | | | CARRIAGE DETAILS | | |
| DESIGNED SRB | | | | | | | | | | | REF DRG NO: - | | |
| APPROVED VP | | | | | | | | | | | DRG. NO 2.04.02.033 | | |
| | | | | | | | | | | | REV RD | | |
| | | | | | | | | | | | SHEET 02 OF 04 | | |

BHAT, GANDHINAGAR-382 428.

INSTITUTE FOR PLASMA RESEARCH

REF DRG NO: -

DRG. NO 2.04.02.033